

# Codel Fiberglass Doors Distinct Features

With high-impact compression-molded skins that will not splinter, dent, rot or rust, Codel's smooth and textured fiberglass doors are virtually maintenance free. Unlike other brands of fiberglass doors that offer only wood edges, our door is designed with "Hydroshield Technology"\* and manufactured with full-length matching composite stiles, and high strength composite top and bottom rails. Having no exposed wood is paramount in preventing moisture from seeping into the door. The Codel fiberglass door, when partnered with our WeatherGuard composite frame system, will not only stand up to the elements, but will also provide years of satisfaction.



## LVL Stile

Continuous 3-1/4" lock block extending the full length of the lock-side, keeps the door from bowing and improves security.



## JambGuard™

Heavy duty steel reinforcement plate for added protection and security.

(\*Not on sidelite or double units.)

## Premium High Dam Sill

Provides an improved barrier against air and water intrusion.

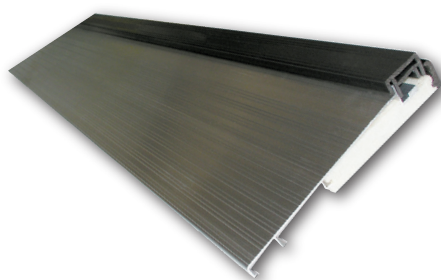

## High Performance Sweep

Provides a tight seal against drafts.

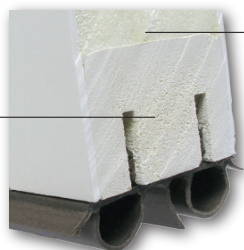

## High Density Polyurethane Foam

Provides 5 times the insulation value of wood doors.

## HydroShield™ Technology\*

Composite framework seals out moisture and eliminates rot and deterioration.

\*Excludes wood edge doors.



## Commercial Ball Bearing Hinges **Standard** on All Fiberglass Doors

This stronger, heavy-duty, hinge keeps your door true and square in the opening, and reduces the risk of sagging.

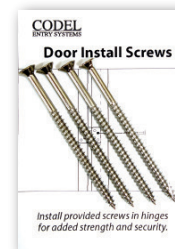

## Door Install Screws

Additional 2-3/4" screws come standard with every prehung unit. Install one in the middle and bottom hinge and two in the top hinge for added security.

## Primed Wood Jambs and Brickmould

Our domestic Ponderosa pine door frames are treated with blue acrylic end sealer to prevent wicking moisture.

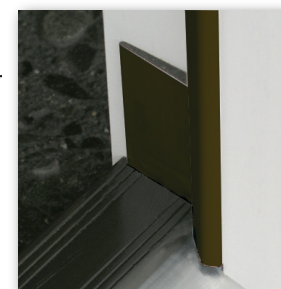
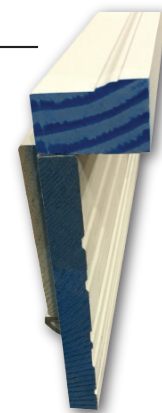

## Corner Seal

Added protection against water and air infiltration.



**CODEL**  
**DOORS**

**plastpro®**  
THE DOOR OF BEAUTY AND INNOVATION